

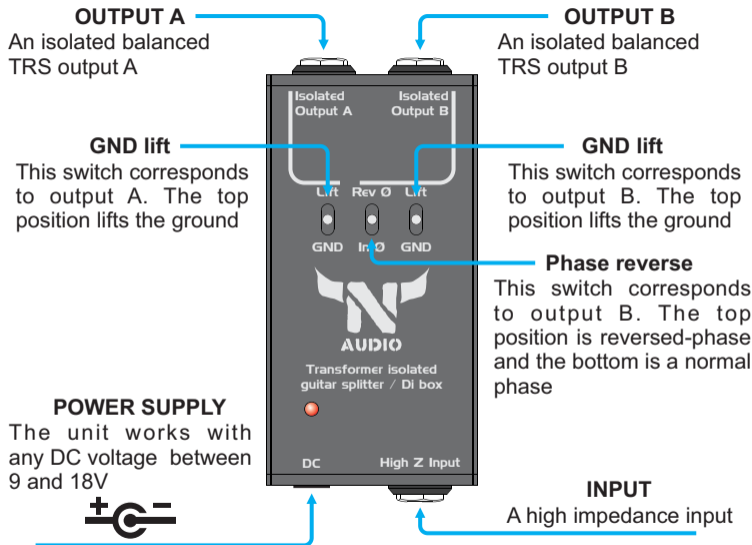

[n-audio.net](http://n-audio.net)



**N-audio**  
**Isolated guitar splitter / DI box**



The N-audio Isolated guitar splitter / DI box is the perfect tool, when you need isolated balanced outputs, in order to prevent ground loops. The unit has a high impedance FET input and two independent galvanically isolated outputs. The heart of the unit is a high-quality audio transformer, which electrically isolates both outputs, eliminating the possibility of ground loops and gives you an excellent common-mode rejection ratio (CMRR). Each output has an independent ground lift switch. Output B also has a phase reverse switch to prevent out of phase signal when two guitar amplifiers are used.

### SPECIFICATIONS

- Input impedance 1 Megaohm
- Maximum input level @ 18VDC: +10dBu (7Vpp)
- Frequency response 30Hz-30kHz  $\pm$ 1dB
- Power consumption 25mA
- Power supply: 9-18 VDC
- Dimensions: W/D/H - 5/10/4 cm
- Weight: 280gr.

[www.n-audio.net](http://www.n-audio.net)

[fb.com/naudiocustom](https://www.facebook.com/naudiocustom)